

## LARYVOX® HME

REF 49800



CE

- ▶ Open pore polyurethane foam HME filter
- ▶ Skin colour to provide inconspicuous design
- ▶ Lightweight; low profile
- ▶ Stable housing – can be closed by light finger occlusion to enable laryngectomized patients to speak
- ▶ Standard variant (REF 49800) with 22 mm adapter (KOMBI) to connect to any conventional base plates
- ▶ Variant with oxygen supply port (REF 49802) and multi-adapter to fit on 15 mm-connectors (UNI) and on 22 mm adapters (KOMBI) to connect to any conventional base plates (e.g. LARYVOX® TAPE) or tracheostomy tubes with 15 mm-connectors or silicone tubes for laryngectomees (e.g. LARYNGOTEK®)

REF 49802



CE 0482

## SCOPE OF DELIVERY

- ▶ Manual

**LARYVOX® HME** **REF 49800**

1 x Filter cassette

or

**LARYVOX® O<sub>2</sub> HME** **REF 49802**

1 x Filter cassette

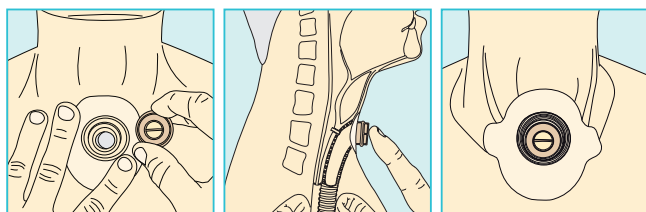

Product	Unit	REF
LARYVOX® HME	30 pieces, individually packed	49800
LARYVOX® O <sub>2</sub> HME	30 pieces, individually packed	49802