

BLOM-SINGER® REPLACEMENT GEL CAPS

- ▶ Replacement gel capsule for placement of a Blom-Singer® voice prosthesis
- ▶ The voice prosthesis is introduced atraumatically into the shunt channel with the aid of the Blom-Singer® Replacement Gel Caps
- ▶ The gel cap dissolves completely in the oesophagus after a few minutes and unfolds the oesophageal flange
- ▶ The gel cap can be coated with a water-soluble local anaesthetic to speed up the procedure
- ▶ Blom-Singer® Replacement Gel Caps are available for shaft sizes 16 Fr., 20 Fr. and 22 Fr.

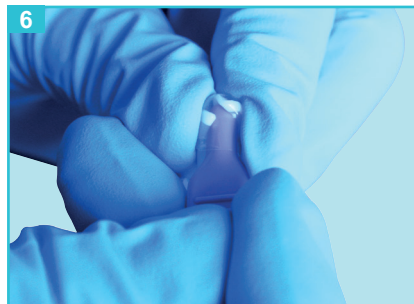
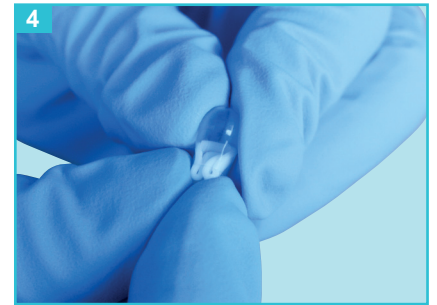
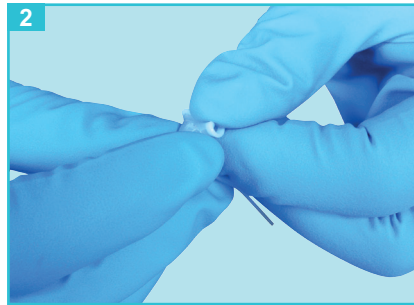
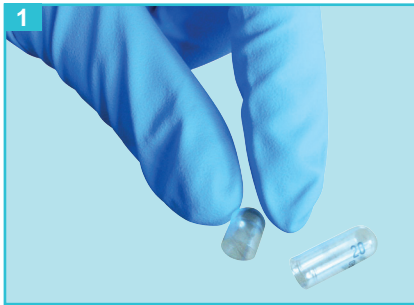

Order information:

Blom-Singer® Replacement Gel Caps	16 Fr.	pack of 90	REF BE3190
Blom-Singer® Replacement Gel Caps	20 Fr.	pack of 90	REF BE3290
Blom-Singer® Replacement Gel Caps	22 Fr.	pack of 60	REF BE3295



Single patient use



Consult instructions for use